

Aquatronica

Instruction Manual



Water Leakage Interface ACQ210N-WL

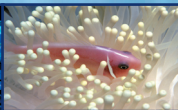

Table of Contents

● General Information	Page 3
● Package Contents	Page 3
● Connection diagram	Page 3
● Connection to Multitester	Page 3
● Sensor state display	Page 5
● Water Leakage Menu	Page 5
Change name	Page 5
Programs	Page 6
Insert	Page 6
Outlet status display	Page 7
Show/Mod/Del	Page 8
Delete all	Page 8
Alarm	Page 9
About	Page 9
● Disconnect	Page 10
● Waste disposal legislation	Page 11
● Warranty	Page 12
● Declaration of conformity	Page 13

CHECK FOR ANY UPDATES ON THIS MANUAL ON THE WEBSITE

The water leakage sensor is a particularly useful accessory for aquarium enthusiasts.

Aquatronica recommends the product "Water Leakage Interface" which makes it possible to connect up to 2 water leakage sensors to the "Multitester" system.

This accessory displays a digital value on 2 levels ("Dry" and "Wet") according to the sensor's state.

Package Contents

You will find:

- One WL probe connection interface.
- One BUS cable for connecting the interface to the Multitester.
- One bag of accessories containing: 1 fixing bracket – 1 kit of cable diameter adaptors – 1 guard – 2 fixing screws.

Connection diagram

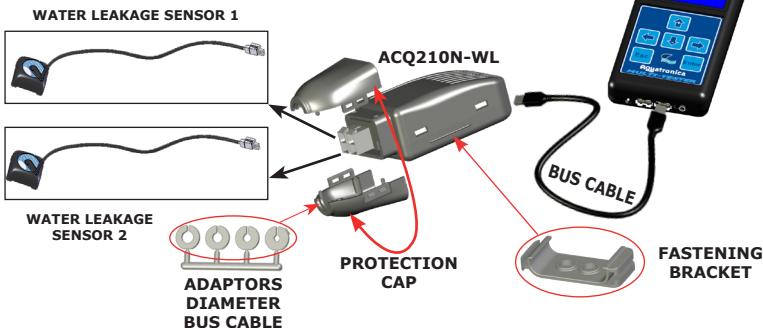

NOTE: one or two water leakage sensors, without distinction, can be connected to the same interface.

Connection to "Multitester" system

1. Connect the WL probe's connector to the interface (ACQ210N-WL).
2. Connect the WL interface to the Multitester (or HUB) using the provided BUS cable.

NOTE: Insert the correct end of the connector into the Multitester; inserting it in the other direction can seriously damage the equipment.

Thanks to the special shape of the box and fixing bracket, the interface can be fitted with others simply and very quickly, as seen below.

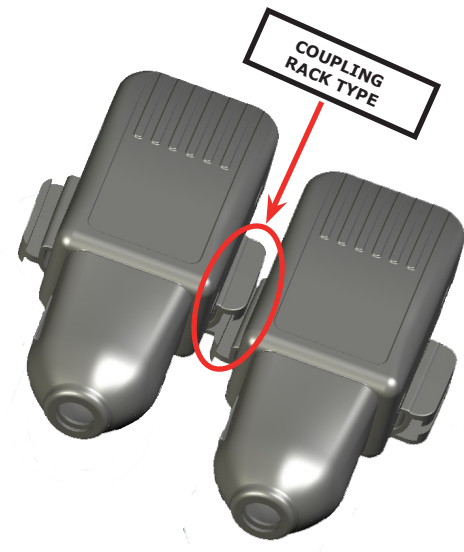
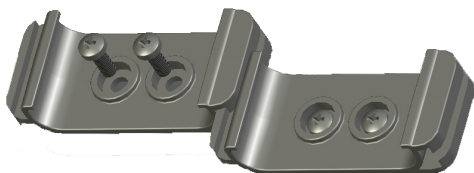

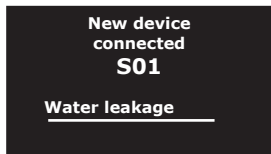

(Fig. 1)

After connection, the control unit will display a Plug-In screen (Fig. 1), where a name can be assigned to the connected sensor.

NOTE: The sensor's name can be changed using the control unit's keypad.

If more than one of these sensors is connected, the user may assign different names for each one to facilitate menu navigation.

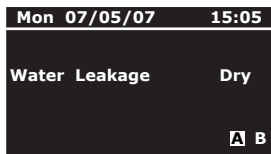

(Fig. 2)

Sensor state display

After the sensor has been connected through the appropriate interface, you can see its state on the main screen (Fig. 2).

If several sensors were connected, their states can be checked in order by pressing the keys \uparrow and \downarrow .

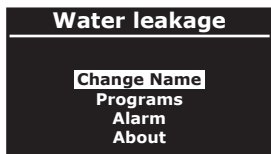

(Fig. 3)

Water Leakage Menu

Once the sensor and interface are connected, the "Water Leakage" menu will appear in the "Main Menu", where all of its settings can be programmed (Fig. 3). All the device setting menus are enabled only when the water leakage sensor is connected to the system.

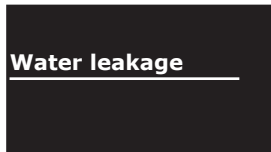

(Fig. 4)

Change Name

This option modifies the name given to the sensor (Fig. 4).

To use this option, proceed as follows:

Main screen \Rightarrow **Main Menu** \Rightarrow **Water Leakage** \Rightarrow **Change Name**.

- Select the letter to insert using the \uparrow / \downarrow keys and move within the word using the \leftarrow / \rightarrow keys. When finished, press "Enter".

Water Leakage

Insert

(Fig. 5)

Programs

Water Leak =

Ref. Wet

OUTA: ON

OUTB: OFF



(Fig. 6)

Mon 11/06/07

15:05

Water Leak Wet



(Fig. 7)

Active outlet

Programs

According to the level of humidity read, activation/deactivation of the sockets of an Easy Plug (ACQ005), if any, connected to the multitester can be controlled.

To insert a program, proceed as follows:



Main screen ⇨ **Main Menu** ⇨ **Water leakage** ⇨ **Programs** ⇨ **Insert**.

- Set the value of reference to be used, which can be selected using the $\uparrow\downarrow$ keys.

- Using the $\leftarrow\rightarrow$ keys, select the output you want to control, while with the $\uparrow\downarrow$ keys you can activate (ON) or deactivate (OFF) the selected outlet (Fig. 6 or 7).

- Using the $\leftarrow\rightarrow$ keys, go to the symbol  in the bottom right corner and press "Enter" to save the program made.

Outlet status display

Icons	Description
	OUTA outlet activated (ON)
A	OUTA outlet deactivated (OFF)
	OUTB outlet activated (ON)
B	OUTB outlet deactivated (OFF)
(No Icon)	Outlet "Undefined"

The icons regarding the Easy Plug OUTA and OUTB outlets are displayed only after their activation/deactivation (ON/OFF) statuses have been defined according to a program pertaining to a connected sensor, and can be seen even with EASY PLUG disconnected.

In the example shown in figure 1, both outputs have been defined (OUTA activated and OUTB deactivated), so they are visible on the main screen (Fig. 1).

If you should want to set the activated/deactivated status of only one of the two outputs, leaving the other one with the default setting (Undefined), the icon of only the defined outlet will appear on the main screen (Fig. 2).

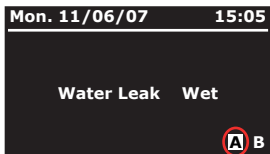

(Fig. 1)

Active outlet

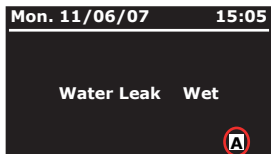

(Fig. 2)

Active outlet

Do you want to
modify or delete?

Modify
Delete Program

(Fig. 8)

Do you want to
delete this
program?

Enter: Confirm
Esc: Cancel

(Fig. 9)

Do you want to
delete all of the
programs?

Enter: Confirm
Esc: Cancel

(Fig. 10)

View/Mod/Del

In this menu the inserted programs can be viewed (View), modified (Mod) or deleted (Del).

To use this function, proceed as follows:

- Access the program to be modified or deleted by pressing **"Enter"** on the **"View/Mod/Del"** field.
- Use the $\leftarrow \rightarrow$ keys to view the desired program (Ex. Fig. 6).
- Press the **"Enter"** key. The specific screen appears on the display (Fig. 8).
- Select **"Modify"** using the $\uparrow \downarrow$ keys to modify the program or change the desired parameters. Then press **"Enter"** to confirm the changes.
- Select **"Delete Program"** using the $\uparrow \downarrow$ keys to delete the program. The delete screen will appear (Fig. 9). Press **"Enter"** to delete or **"Esc"** to cancel.

Delete All (Fig. 10)

In this menu all of the programs inserted in the menu can be deleted at one time.

To use this function, proceed as follows:

- Select **"Delete All"** using the $\uparrow \downarrow$ keys and press **"Enter"**. The delete screen will appear. Press **"Enter"** to delete or **"Esc"** to cancel.

Alarm

Dry	With Sound
Wet	Without Sound

(Fig. 11)

Alarm (Fig. 11)

A visual and acoustic alarm can be enabled in this menu to warn if the water leakage sensor takes on certain state.

When the "Wet" state is reached, the detected state blinks on the main screen if the alarm is set to "**Without Sound**".

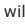
If the alarm is set to "**With Sound**", the value will blink, an acoustic signal will sound and the icon  will appear on the main screen.

In addition to the blinking detected state, a blinking icon will appear on the main page indicating the alarm (.

To program this function, proceed as follows:

Main screen ⇨ **Main Menu** ⇨ **Water Leakage** ⇨ **Alarm**.

Aquatronica

FW Version: x.y

Press any key
to continue

(Fig. 12)

About (Fig. 12)

Provides information on the control unit's firmware version.

To use this function, proceed as follows:

Main screen ⇨ **Main Menu** ⇨ **Water Leakage** ⇨ **About**.

WARNING

PREVENT THE SENSOR FROM COMING INTO CONTACT WITH HANDS OR CONDUCTOR MATERIALS (E.G. METALS)

Device Disconnected

S01: Water leakage

(Fig. 13)

Mon 11/06/07 15:05

?

(Fig. 14)

Water leakage

Change Name
Programs
Alarm
Disconnect

(Fig. 15)

Disconnect

Conductivity

Enter: Confirm
Esc: Cancel

(Fig. 16)

Disconnect

If the water leakage sensor is disconnected, a message will appear on the display (Fig. 13). Press **"Enter"** to indicate that the message has been read.

On the main screen the "?" icon will appear in the lower left corner (Fig. 14).

If the water leakage sensor is reconnected, the control unit will automatically begin displaying the read value again.

To definitively eliminate the water leakage sensor from the system, after disconnecting it, proceed as follows:

Main screen ⇒ **Main menu** ⇒ **Water leakage** ⇒ **Disconnect**.

The **"Disconnect"** function appears (Fig. 22).

- Select this function using the $\uparrow\downarrow$ keys and press **"Enter"**.

- The disconnection screen will appear (Fig. 23). Press **"Enter"** to disconnect or **"Esc"** to cancel.

DISPOSAL OF ELECTRIC AND ELECTRONIC PARTS

Pursuant to Article 13 of Legislative Decree No. 151 of 25 July 2005, "Implementation of **Directives 2002/95/CE, 2002/96/CE and 2003/108/CE regarding the reduction in use of dangerous substances in electrical and electronic equipment, as well as waste disposal**":



Products bearing the barred dustbin symbol must be disposed of separately from other waste.

The user must therefore dispose of the product in question at suitable recycling centers for electronic and electro-technical waste, or he/she must turn over the used product to the retailer when buying a new equivalent product, on a one-to-one basis.

Separate waste collection allows used equipment to be recycled, treated and disposed of without negative consequences for the environment and health, and it allows the materials in the equipment to be recycled. Illegal dumping of the product by the user entails the administrative sanctions stated in Legislative Decree No. 22/1997 (Article 50 et seq of Legislative Decree No. 22/1997).



Separate collection of used products and packaging allows materials to be recycled and used again. Reuse of recycled materials helps prevent environmental pollution and reduces the demand for raw materials.



Local regulations may provide for the separate collection of household appliances at municipal waste sites or retailers when a new product is purchased.

Warranty

Dear Customer,

Thank you for the trust you have placed in **AQUATRONICA** by purchasing this product. **AQUATRONICA** subjects all its products to severe quality tests. If, in spite of the controls, the product should malfunction, we recommend you immediately contact the dealer/producer for any checks or interventions necessary.

- General warranty regulations

AQUATRONICA guarantees that this product operates properly and that it is free of manufacturing faults and defects. If the product becomes defective during the warranty period, **AQUATRONICA** will repair or replace it. Defective parts will be replaced ex-works **AQUATRONICA**'s plant (recipient responsible for shipping expenses). Accessories and components not made by **AQUATRONICA** are covered by their manufacturers' warranties only. This is the only warranty offered by **AQUATRONICA**. All others are excluded. Unless due to malice or gross negligence, **AQUATRONICA** is not responsible for injury to people or damage to things resulting from product malfunctioning.

This warranty is valid only for those up to date with their payments.

- Conditions

The warranty will be valid for a period of **24 months from the date of purchase** only upon presentation of this certificate, which must bear the retailer's stamp, the date of sale and the product's serial number, accompanied by the invoice or receipt issued by the retailer, indicating the serial numbers of the installed products. **AQUATRONICA** can refuse to recognize the warranty if this information is incomplete or has been tampered with after purchase. The warranty will be valid only if, at the time of purchase, the product was properly stored as it was originally packaged by **AQUATRONICA**, who alone can ensure its origin and adequate protection.

- Warranty exclusions

This warranty does not cover:

- a)** periodic checks, maintenance, repairs, or replacement of parts due to normal wear;
- b)** malfunctioning due to negligence, incorrect installation, improper use or non-observance of the technical instructions and, in general, any malfunction not traceable to manufacturing faults or defects of the product and therefore the responsibility of **AQUATRONICA**;
- c)** products modified, repaired, replaced, installed or in any way tampered with by anyone without the prior written authorization of **AQUATRONICA**;
- d)** accidents originating from force majeure or other causes (e.g. water, fire, lightning, bad ventilation, etc.) not depending on **AQUATRONICA**.

Products with manufacturing faults or defects recognizable through normal diligence must not be resold or installed. The sole competent court for any disputes concerning the interpretation or execution of this warranty is that of Reggio Emilia (Italy).

Product code: _____

Serial number:

--	--	--	--	--	--	--	--	--	--	--	--	--	--	--	--	--	--	--	--

Day

Month

Year

Date of purchase:

--	--

--	--

--	--	--	--

Retailer's stamp

Declaration of Conformity

DECLARATION OF CONFORMITY



Standard of reference ISO/IEC Guide 22 and EN 45014

Number of conformity: 005-2007/E

Name of the manufacturer: **Aquatronica division of A.E.B. srl**
Address: via dell'Industria, 20
Corte Tegge
42025 Cavriago (RE) Italy

DECLARES THAT THE ELECTRONIC UNITS

Code: **ACQ210N-RX** (REDOX sonde interface)
ACQ210N-PH (PH sonde interface)
ACQ210N-TL (temperature and level sonde interface)
ACQ210N-MS (conductibility sonde interface)
ACQ210N-D (density sonde interface)
ACQ210N-WL (water-leakage sonde interface)

ARE IN COMPLIANCE WITH THE FOLLOWING PRODUCT SPECIFICATIONS:

FIELD	Directive	Description	References	Test Result
EMC	2004/108/EC	EMC directive	Official Journal of the European Union L390 December 31 2004	applied

THEREFORE THEY ARE IN COMPLIANCE WITH THE REQUISITES OF THE CE MARK

The equipment was checked in a typical working configuration

Place of issue: **Cavriago (RE) Italy**

Date of issue: **12/04/07**

The A.E.B. srl legal representative
Paterlini Ivan

The logo for Aquatronica features the word "Aquatronica" in a white, bold, sans-serif font. The letter 'A' is stylized with a blue water droplet shape on its left side. Below the letters 'a', 't', and 'r' are three wavy lines representing water, colored in shades of blue and green. The entire logo is set against a background of light blue, rippling water.

Aquatronica

A.E.B. Srl Division

Via dell'Industria, 20 - 42025 Cavriago (RE) Italy

Tel.: +39 0522 494403 Fax: +39 0522 494410

<http://www.aquatronica.com>

E-mail: service@aquatronica.com